



EAMEN RAH NAMA SAMAN Co

WE ARE ALWAYS WITH YOU ...



CONTACT



+98913 1176618

+98913 1282171

+9831 52374527-9



info@erns.ir

www.erns.ir



Mobarakeh Industrial Town,
Isfahan, Iran.



@eamen.rah.nama.saman

**Consulting, design
and production of traffic
and lighting equipment**

Base with an octagonal section



Technical Specifications

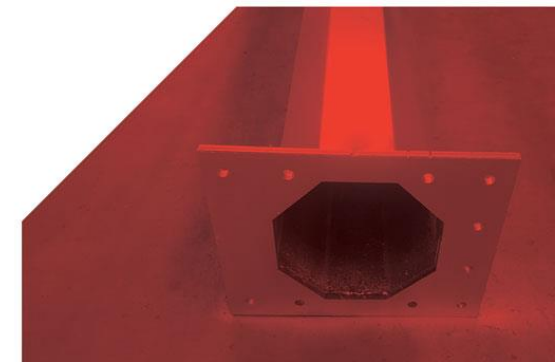
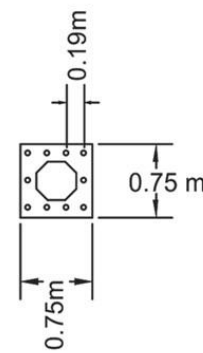
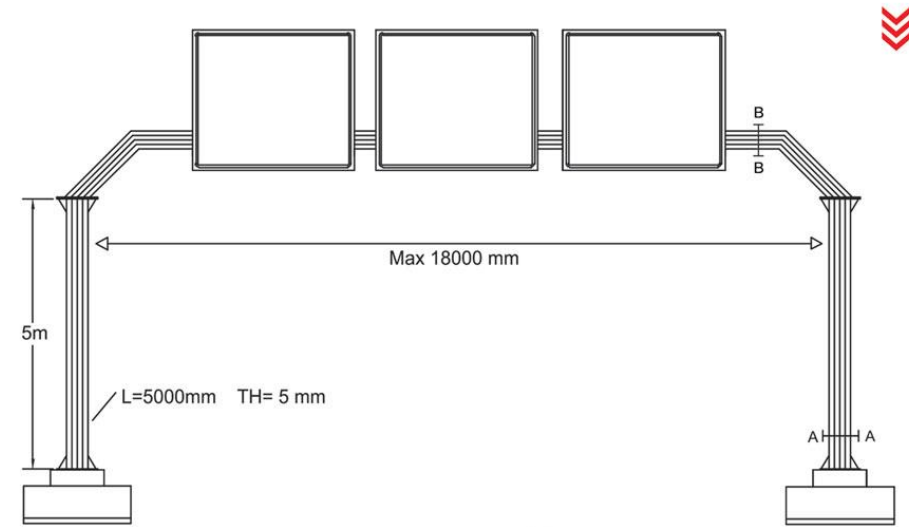

T Base with an octagonal section

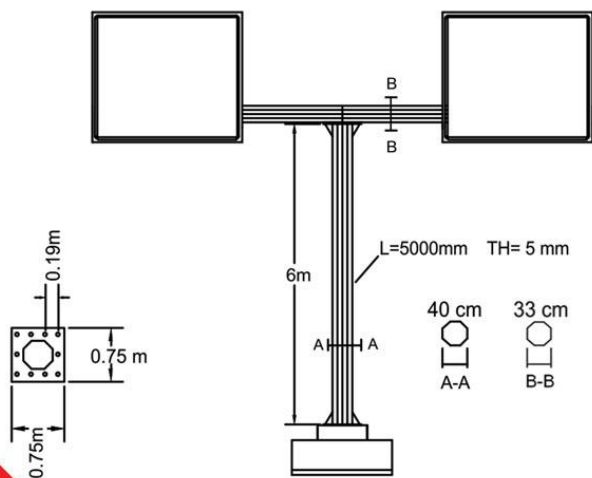

Technical Specifications

L Base with an octagonal section

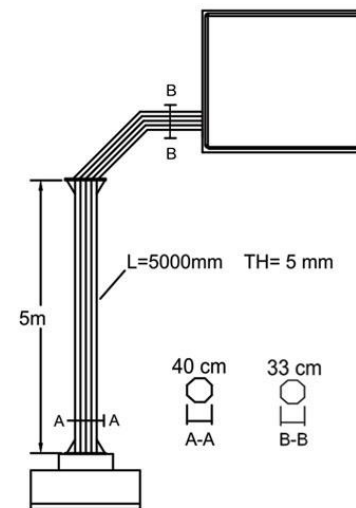
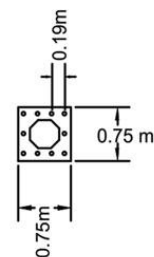

Foundation

(For base with an octagonal section)

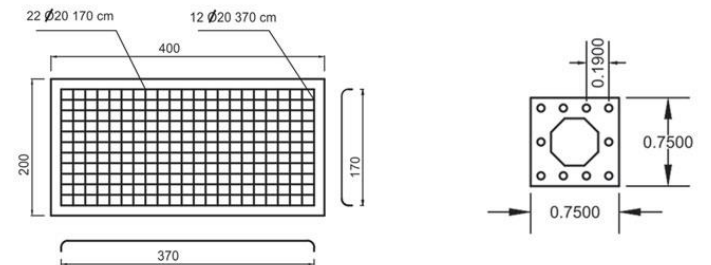
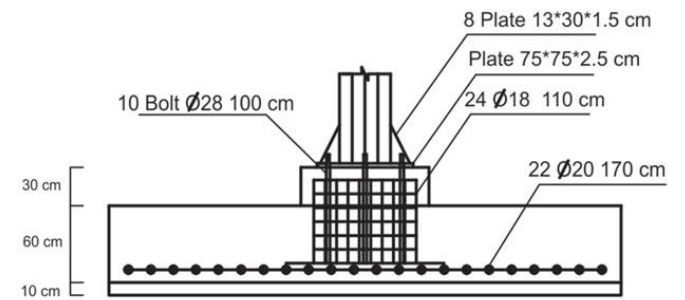

Base with a circular cross-section



Technical Specifications

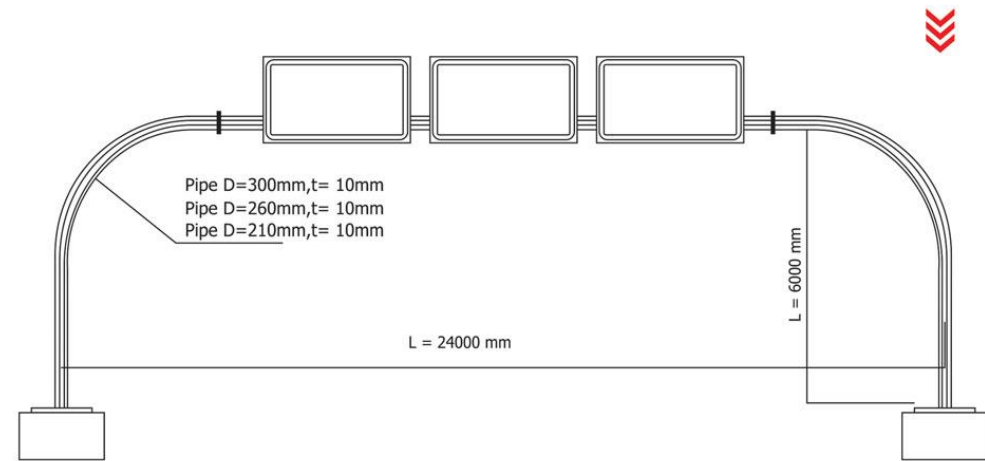

D=8,10,12 inch

L = 10
D=8,10,12 inch

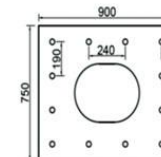

T Base with a circular cross-section



Technical Specifications

L Base with a circular cross-section

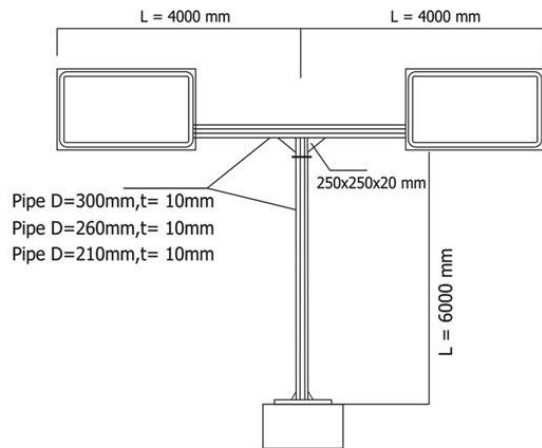

$D=8,10,12 \text{ inch}$

$L=10$
 $D=8,10,12 \text{ inch}$

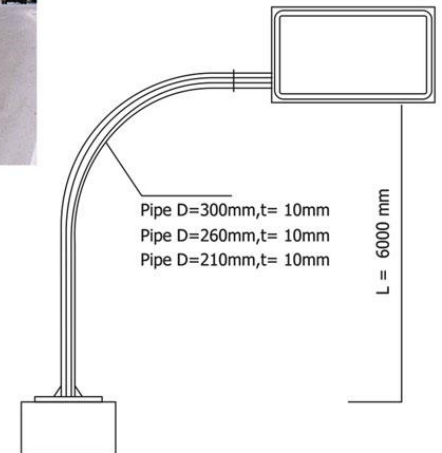
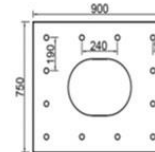

Foundation

(For base with a circular cross-section)

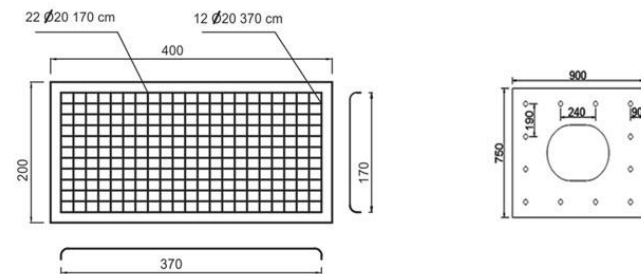
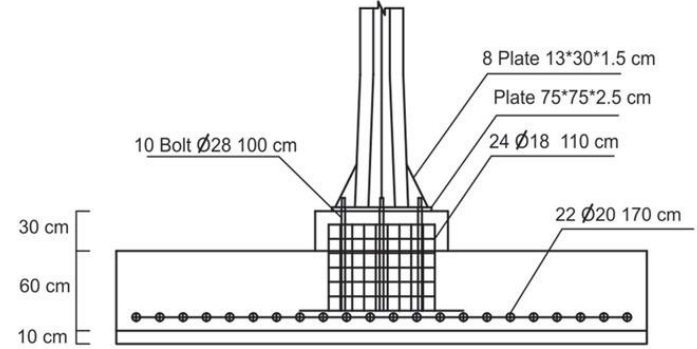

Base with a circular cross-section



Technical Specifications

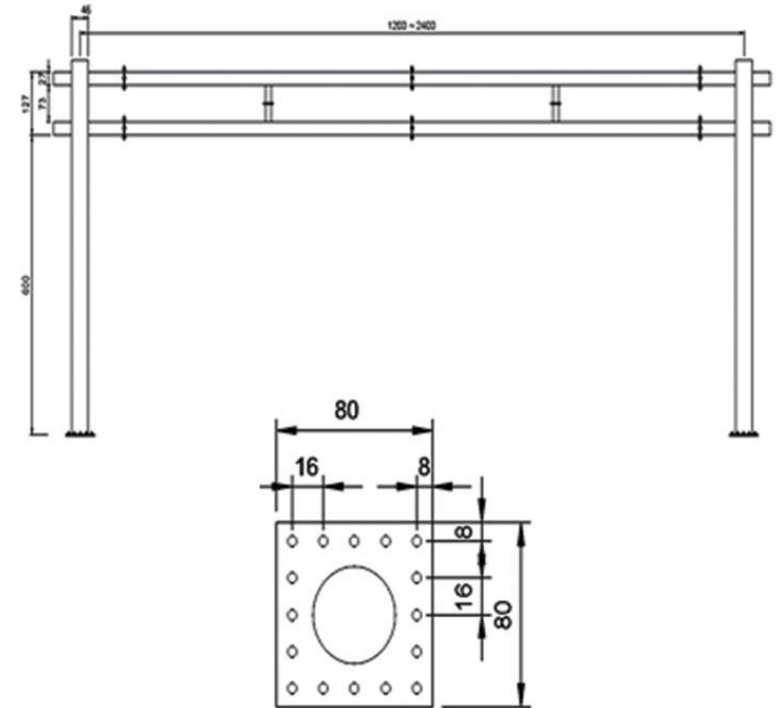

Road information BOARD



Technical Specifications

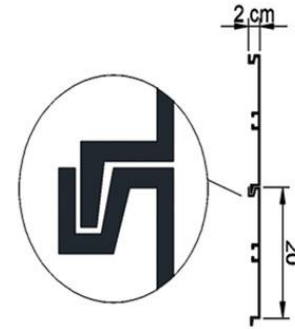



Traffic Sign



Traffic Sign



01 Circle with diameter : 60 - 75 - 90 - 120 cm

Thickness : 1.25 - 1.5 mm
Coating : Galvanized
Framed



03 Triangle with side : 60 - 75 - 90 - 120 cm

Thickness : 1.25 - 1.5 mm
Coating : Galvanized
Framed



02 Square with side : 60 ~ 125 cm

Thickness : 1.25 mm
Coating : Galvanized
Framed



04 Octagon with diameter : 60 cm

Thickness : 1.25 mm
Coating : Galvanized
Framed



Traffic Sign



Traffic Sign



05 Rectangle with sides : 20*60 cm

Thickness : 1.25 mm
Coating : Galvanized
Framed



07 Circle with diameter : 37 cm
Rectangle with sides : 33*50 cm

Thickness : 1.25 mm
Coating : Galvanized
Framed



06 Square with side : 40 cm

Thickness : 1.25 mm
Coating : Galvanized
Framed



08 Rectangle with sides : 50*70 cm

Thickness : 1.25 mm
Coating : Galvanized
Framed



Road name board



» Board dimensions : 110*80 cm

Total hight : 300 cm
Base type : octagon
Base plate : 25*25*1



» Board dimensions : 75 & 40 cm

Total hight : 300 cm
Base type : pipe 1.5" * 2
Base plate : 25*25*1



» Board dimensions : 75 & 40 cm

Total hight : 300 cm
Base type : pipe 1.5" * 2
Base plate : 25*25*1

Alley name BOARD



» Board dimensions : 33*80 cm

Tickness : 2 mm
Base high : 300 cm
Base diameter : 1.5" & 1"
Base plate : 25*35 cm



Board dimensions : 33*80 cm «

Tickness : 2 mm
Base high : 300 cm
Base diameter : 2.5"
Base plate : not have



SAFETY SIGN

خطر مواد قابل اشتعال
Flammable Material

از گوشی داخل گوش
روى گوش توام استفاد
Ear Muff and Ear Plug

ورود بدون لوازم ایمنی
No PPE

با دست روئنی و جرب
گوشول کشولن یا کشول

شور یا ضربه بار کشید
کشول یا با آهال کشولن بار کشید
برای عمل

✓ **Dimensions :**
according to order

✓ **Material type :**
aluminium

✓ **Thickness :**
according to order

✓ **Type of writing :**
printing on the reflective sheet and photoluminescent sheet or direct printing



SAFETY SIGN



- ✓ **Dimensions :** according to order
- ✓ **Material type :** aluminium
- ✓ **Thickness :** according to order
- ✓ **Type of writing :** printing on the reflective sheet and photoluminescent sheet or direct printing



▼ Lighting Base

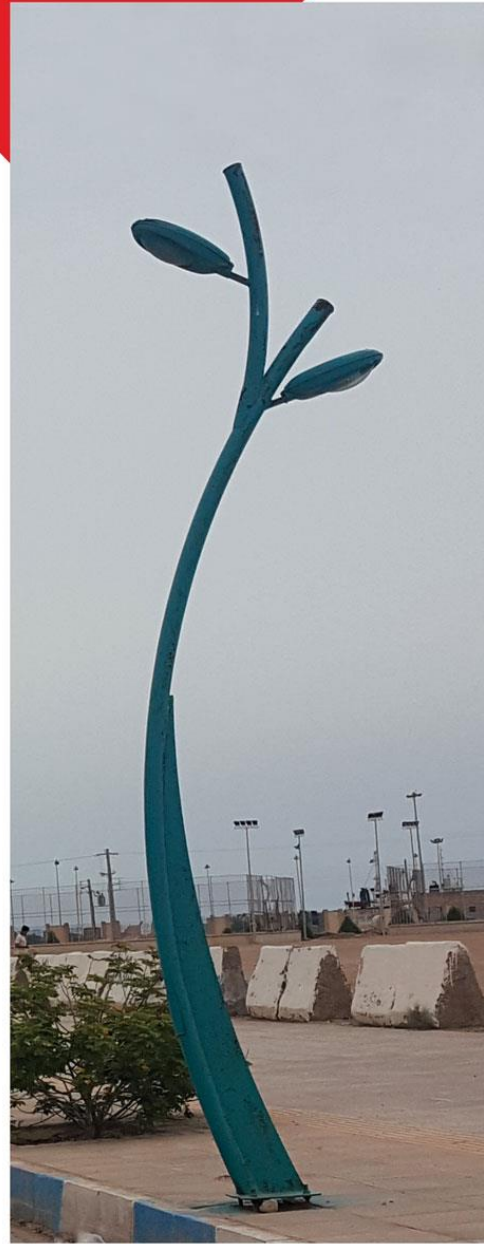

Flag Stand



Lighting Tower

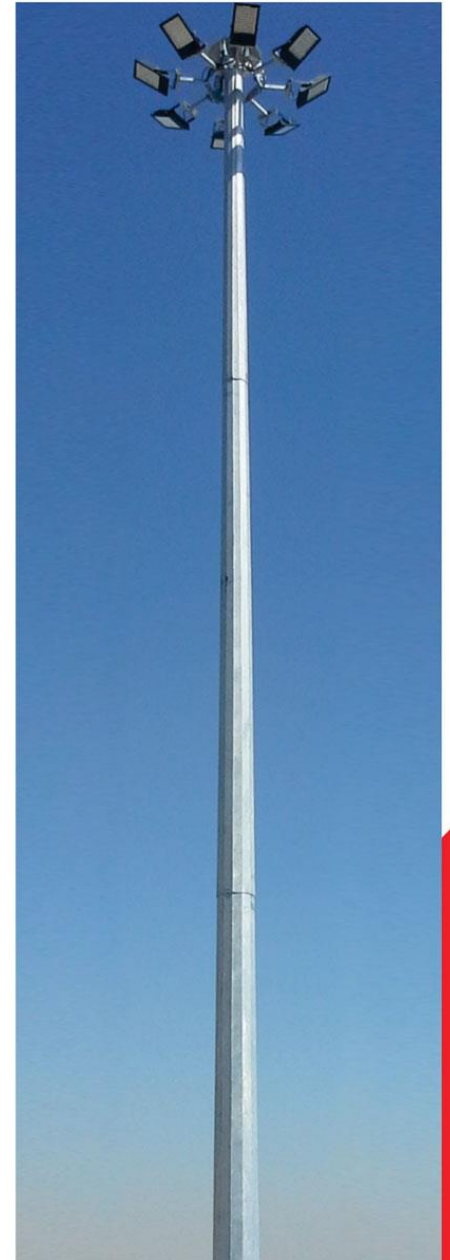
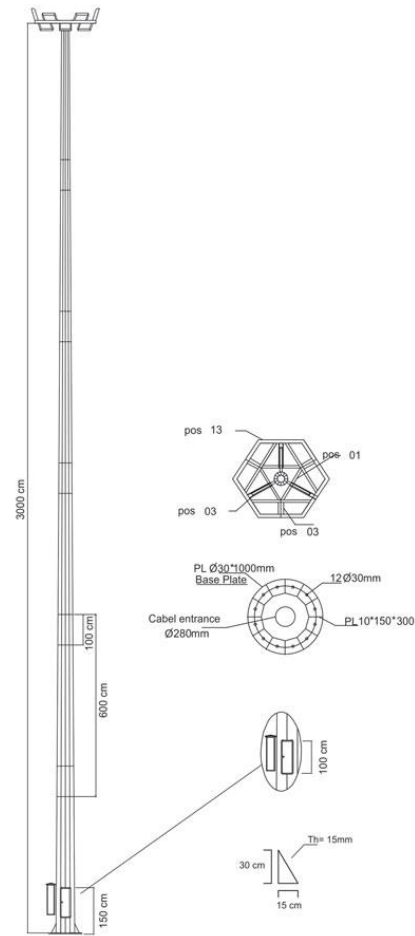

Traffic light & base

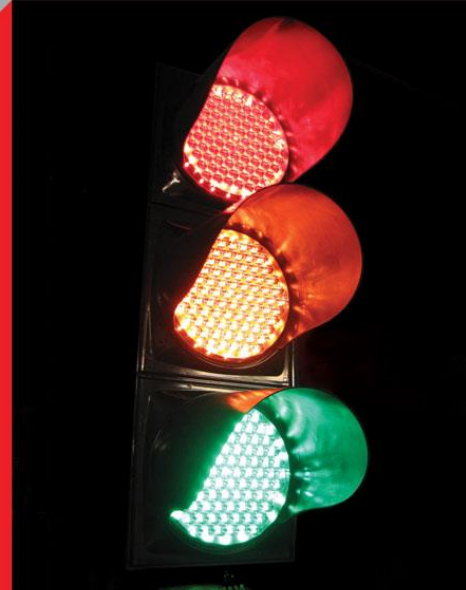

Technical Specifications

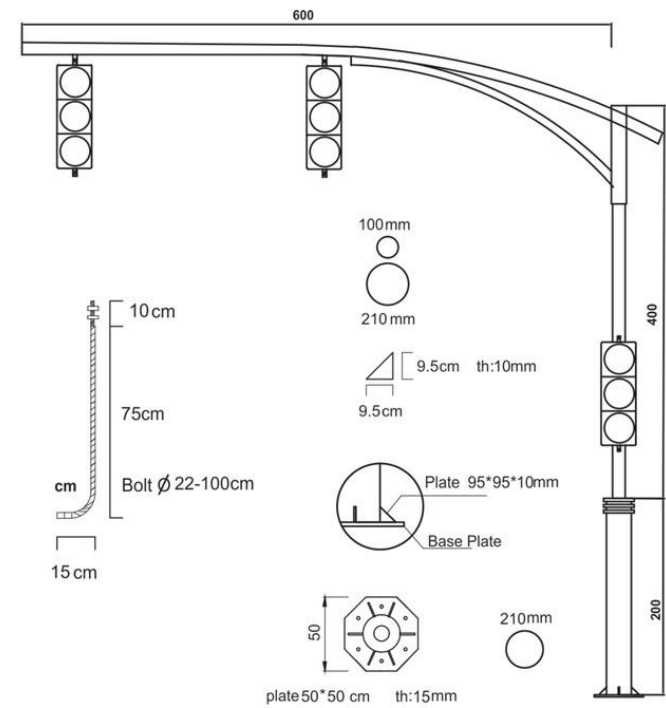

Traffic equipment



Urban furniture



Urban furniture

